



speCtra

SPECTRA Wearable

INSTRUCTION FOR USE

Contents

02 [Things to know before use]

- 02 • Precaution for safety
- 04 • Components
- 05 • Product description and additional functions

06 [How to Use]

- 06 • What to do before use
- 07 • How to clean and assemble before use
- 08 • How to assemble
- 09 • How to use

11 [Troubleshooting]

- 11 • Measures in case of Backflow
- Self-checking

12 [Use and storage environment]

13 [Specifications]

14 [Limited warranty]

[Things to know before use]

- Precaution for safety

1. General precaution

This device is medical device and personal use

- Please be careful when sharing this device with other people as problems such as cross infection may occur.
- The other components except the main body of the wearable breast pump are consumables. Because this device comes into contact with breast milk, the user must use/keep the device clean, and must not share it with other people.
- Please use genuine Spectra components only. If you do not use a genuine component, problems such as backflow are likely to occur.
- The recommended period of use of the components is 3 months. The period of use of components may vary depending on the user's environment and frequency of usage.
- Symbols that the users should pay attention to when using the device



warning



BF Type device



Class 2



ON/OFF



refer to manual



AC



DC

[Things to know before use]

2. Basic Matters

- 1) The breast pump is a personal use device. Standards of hygiene must be maintained. If you use a secondhand product or a rental product, you should pay attention to a risk of a warranty period or a cross infection.
- 2) The product has an automatic OFF function after the user operates it for 30 minutes. However, if you fall asleep or become drowsy, you must stop using the product immediately.
- 3) If the feeding bottle is full of breast milk, a risk of backflow may occur. Thus, be careful not to completely fill the feeding bottle up with breast milk.
- 4) The user may experience some discomfort (not pain) in the early stages of using the breast pump. If pain continues, or if you have sore or bleeding nipples, you should see a doctor immediately.

3. Safety of product

- 1) Keep the product dry and never immerse in water or other liquids.
- 2) Avoid contact with a radiator or flame.
- 3) Do not drop the product.
- 4) Never use a damaged product.

4. Safety related to electricity

- 1) Use dry hands when connecting and disconnecting an adapter.
- 2) Use only the adapter supplied with the product.
- 3) If the product gets wet, use it after servicing.
- 4) Do not use the product during bath and shower.

[Things to know before use]]

• Components

Components of breast pump

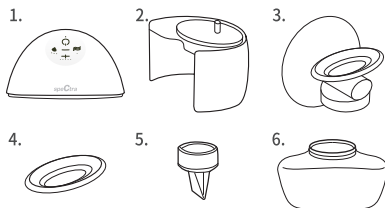

Other components



1. Wearable Breast Pump
2. Wearable cover - a cover that connects the main body and the wearable funnel
3. Wearable breast shield - a part that attaches to the breast for breast pumping
4. Wearable silicone membrane - assembled on a wearable breast shield to prevent backflow of breast milk into the main body
5. Wearable silicone valve - a valve that pumps breast milk into the bottle
6. Wearable bottle - a bottle used to keep the pumped breast milk
7. Bottle connector - used when connecting a screw cap or an airtight cap to the wearable bottle
8. Connector pin - helps the wearable feeding bottle and the feeding bottle connector to be more securely fastened
9. Airtight cap - a lid that seals the bottle so you can store the pumped breast milk immediately (wearable feeding bottle, or Spectra pp bottle is compatible)
10. PP bottle - a bottle used to store and feed the pumped breast milk
11. Nipple- used after connecting it to the screw cap when feeding the pumped breast milk
12. Screw cap - the middle cap that connects the pacifier to the feeding bottle
13. Cover- lid of the bottle
14. Adapter - a device that provides power to the breast pump.

[Things to know before use]

- Description about outward appearance and additional functions

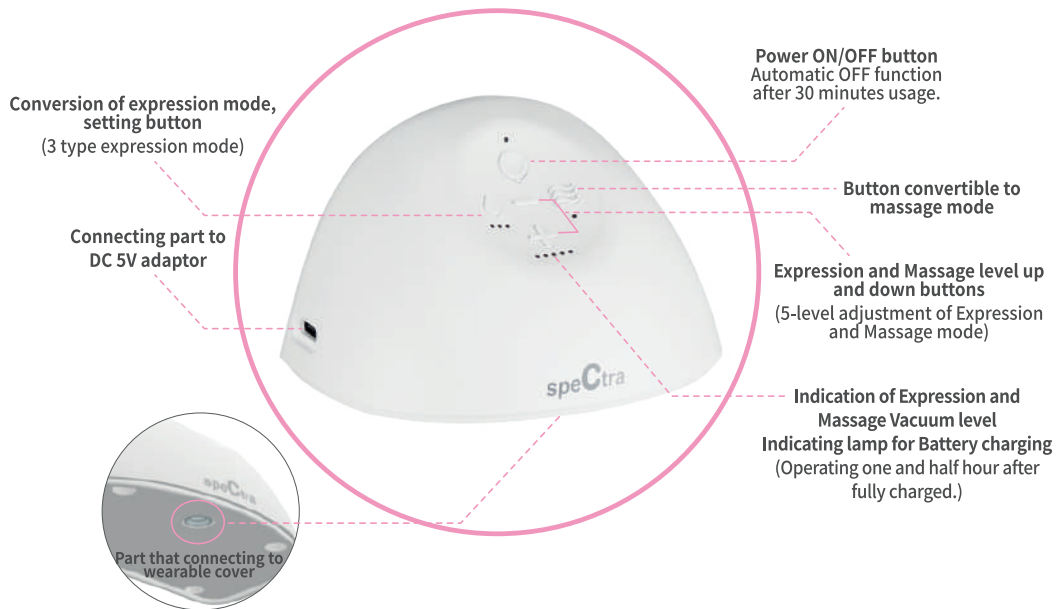

[How to Use]

- What to do before use

1. Before use, wash your hands thoroughly, and dry them completely. Also, before breast pumping, make sure that the breasts are clean and dry, and there are no foreign substances left.
2. Before use, check that the components that come into contact with breast milk are properly cleaned and disinfected, and assemble the components according to the method described in the manual for the user.
3. If you do not use the breast pump in the correct posture, breast milk may flow backward, so you must maintain the correct posture while breast pumping



Sit with your back straight(O)



Fully lying on the floor(X)



Lie with your face downward(X)

[How to Use]

- How to clean and assemble before use

1. How to clean

- 1) Do not wash the main body and adapter, and wipe them with a dry towel.
- 2) Other components are washable. After separating them, wash them with a feeding bottle detergent.
 - Components : Wearable cover, Wearable breast shield, Wearable silicone membrane, Wearable silicone Valve, Wearable bottle, Bottle connector, Connector pin, Airtight cap, Screw cap, PP bottle, Nipple, Cover
- 3) After washing, sterilizing with boiling water is common, but the sterilization method may differ depending on the material used.
- 4) When disinfecting in boiling water, strictly adhere to the disinfection time according to the material.

- PA (wearable bottle) : within 3minutes
- PP (all plastics except wearable bottle): 1 minute
- Silicone (Wearable silicone Membrane, Silicone Valve, Nipple): within 30 seconds

- 5) After sterilizing in boiling water, rinse several times in clean water and air dry.
- 6) Keep parts covered when not in use.
- 7) Deformation or discoloration may occur during long-term UV disinfection. Please use it without anxiety as there is no change in properties or there is nothing wrong with the product.

[How to Use]

2. How to assemble

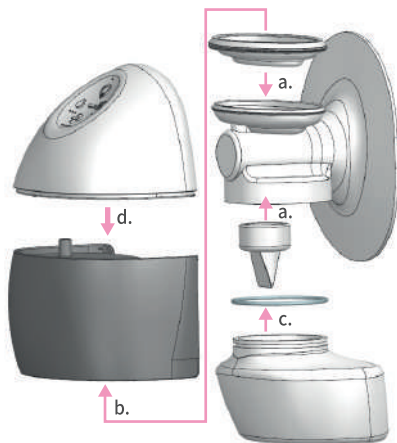

- Insert the wearable silicone valve and the wearable silicone membrane into the wearable breast shield.
- Combine the wearable cover with the wearable breast shield.
- Insert the wearable bottle into the wearable breast shield.
- Connect the assembled wearable breast shield with the wearable breast pump and start using the product.

[How to use]

• How to use

1. Wash your hands and wipe your breast with a warm towel. The use of alcohol is prohibited.
2. Attach the product to your breast. At this time, make sure that the nipple is in the center of the inner tube of the funnel.
3. Fix the product in close contact with the breast by using a breast-feeding bra. Ensure the bra is good and tight fit.
4. Press the power of the product. The previously used set value is stored in the memory and the device starts with the previously used set value, so use the device after checking whether the vacuum level is not too high.
5. Press the massage mode conversion button to set the massage mode in order to massage the breast before breast pumping.
6. In the massage mode, you can adjust the massage level by the + or - button. (1~5 level)
7. After massaging the breast sufficiently, press the expression mode conversion button to set the expression mode.
8. There are 3 types of expression mode, set the expression mode that suits you, and press the + or - button to adjust the vacuum level. (3 types of expression mode, 1~5 level)



9. When you finish pumping, lower the pressure level and turn off the power, with your upper body lowered, you insert your finger into the funnel attached to the breast and separate it slowly.

[How to use]

10. You can feed the pumped breast milk immediately or keep it, or move it to a general feeding bottle or a breast milk storage pack for use later. ※ At this time, connect the upper part of the connector pin so that it can cover the bottle connector.

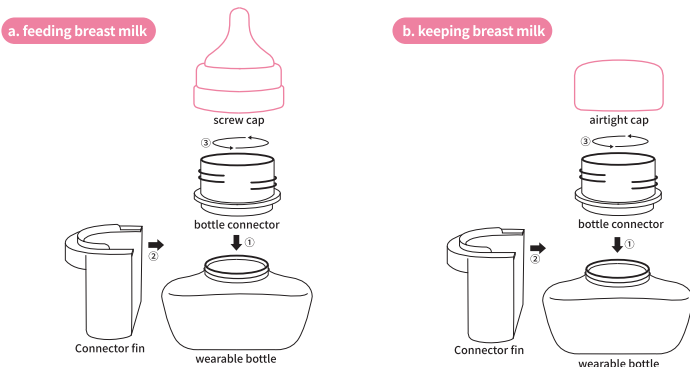

• How to keep and manage after use

1. Immediately after use, disassemble all components that come into contact with breast milk according to the user's manual, and wash the all the disassembled components thoroughly under running water to ensure that no breast milk remains with a feeding bottle detergent.
2. For the cleaning method, refer to '1. How to clean' of 'How to clean and assemble before use'.
3. After washing and disinfecting, air dry completely. Store it in a storage container or in a clean place, and be careful not to touch the parts that comes into contact with breast milk until the next pumping session.

[Troubleshooting]

- Measures in case of backflow

1. If it is suspected that breast milk flows backward into the main body, stop using the product immediately and contact the customer service center of the company to ensure the product is functioning properly.

- Self-checking

Q. The suction pressure of the breast pump does not occur or seems to have dropped?

- A. In the event that the silicone valve is damaged, the vacuum may drop. Check that there is no tear other than a cut on the silicone valve and be careful when cleaning.
- A. Check that the silicone valve is not slipped off. If milk fat of breast milk remains in a component, the silicone valve may slip off. Please, clean/disinfect the silicone valve connection part and the inside of the silicone valve with a detergent.
- A. After checking whether silicone membrane is properly assembled, try reassembling it.
- A. If you continue breast pumping for a longer time, you may feel less vacuum as your mammary glands develop. In this case, try increasing the pressure level.

If the problem is not resolved even after performing the above-mentioned self-checking, please contact a customer service center.

[Use and storage environment]

C ondition	Possible Causes	C hecks	Solutions
No Power	Battery discharged	Check the battery indicator.	Using the power cord/AC Adapter, connect the pump to an appropriate power source.
No Suction	Silicone valve	Check if they are connected to breast shield properly.	Attach valve to breast shield— Twist valve into breast shield to attach. If valve check for tear/damage
Low Suction	Vacuum Level	Check vacuum level	Increase vacuum level.
	Silicone valve	Check if there is damaged in the silicone valve —tear or other damage	Replace the silicone valve
Pain	Vacuum Level	Too high suction	Set to a lower vacuum level.

Use and storage environment

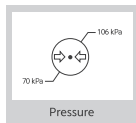
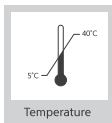

Environment to Use

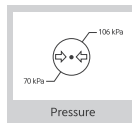
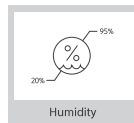
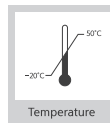

Environment to storage

[Specifications]

Protection Type : Class II

Weight : 305g

Expected Spectra Wearable Service Life is 3 years

The following adapter must be used.

Input: 100-240 V~ 50/60 Hz, 500 mA

Output: 5V \equiv 2A

Battery : Li-Polymer 3.7V, 1,500mAh

1. Type of protection against electric shock: Class II equipment
2. Degree of protection against electric shock: Type BF applied parts
3. Classification according to the degree of protection against ingress of water: IP22
4. This equipment is not suitable for use in the presence of flammable anesthetics or oxygen
5. Mode of operation: continuous operation

[Limited warranty]

This is designed to be a personal use product. Using breast pump by an individual other than the original owner presents health and performance risk and voids the product warranty.

This product is warranted by where you purchased in your country to the original retail purchaser to be free from defects in material and workmanship for the period of 1 year.

This warranty does not cover damage caused by accident, misuse, abuse, improper maintenance, unauthorized modification, or connection to an improper power supply. A charge will be made for repair of suction damages.

Spectra Wearable breast pump	
Name	
Contact number	
Address	
Place of purchase	
Date of purchase	



speCtra