



Instruction For Use



To prevent the risk of accidents or damage to the product,
It is essential to read these instructions before installation and using it for the first time.
Use only genuine original Spectra power cord and parts.
The product's color and design may change for quality improvement purposes.

Spectra Baby Bottle UV Sterilizer User Instructions

Contents

1. Safety instructions before use	3
2. Important safegaurd	3
3. Components	4
4. Specifications	4
5. Components	5
6. Unit installation and UV lamp replacement instructions	6~7
7. Operating instructions	8~10
8. How to use sterilizer	11
9. Troubleshooting	11
10. Limited warranty	12

1. Safety instructions before use

- 1) This guide covers appliance specifications, safeguard and instructions.
Ensure you read all instructions before first use.
 - 2) Installation of stainless shelf/basket may cause scratch to internal surface, and will result in exchanges or returns not being accepted.
 - 3) Do not sterilize items that should not be exposed to UV light (e.g. products that contain latex).
 - 4) The inside of the appliance should be kept dry to maintain its sterile state.
 - 5) The power cord must be genuine Spectra part.
 - 6) UV lamp must be replaced periodically.
(May vary depending on usage period, but replacement every 6 months is recommended)
 - 7) The air filter must be cleaned periodically under running water to remove any dust.
 - 8) The appliance is not intended for use by persons (including children) with reduced physical, sensory or mental capabilities, or lack of experience and knowledge, unless they have been given supervision or instruction concerning use of the appliance by a person responsible for their safety.
 - 9) The appliance should be installed in location out of children's reach to ensure that they do not play with the appliance.
 - 10) If the power cord is damaged, it must be replaced by the manufacturer or an authorized technical service center in order to avoid all risk.
-

2. Important safeguard

Read all safety instructions below before using the product.



Safety cautions

- 1) Avoid areas that are highly humid or exposed to water splash.
- 2) Do not use in places with damaged power cord or outlet.
- 3) Do not handle the plug with wet hands.
- 4) Do not unplug by pulling on cord.
- 5) Do not connect multiple plugs to the power outlet.
- 6) Install in locations out of reach of children.
- 7) Do not disassemble or modify the product
- 8) If the plug has dust or water, clean it well with dry cloth before use.
- 9) If there is a gas-leak present, do not operate the appliance and ventilate the room by opening doors and windows.
- 10) Do not place living things in the appliance.
- 11) If there is unusual sound/smell/smoke, close the door of the appliance, unplug the power cord and contact Customer Center.
- 12) In the event of product damage either externally or internally, do not use the appliance and contact the Customer Center.



Safety warnings

- 1) Never look directly at the UV lamp when it is operating and avoid direct contact with skin.
- 2) The appliance should be installed on a flat surface.
- 3) Ensure that items placed inside the appliance do not touch the door of the unit.
- 4) Do not block the air ventilation inlet/outlet of the appliance.
- 5) Do not place thin vinyl items in the appliance.
- 6) Do not unplug the power cord of the appliance during operation.
- 7) Do not place items on top of the appliance.
- 8) Do not step on the appliance or pull down on the door of the unit.

3.Components



Spectra UV sterilizer

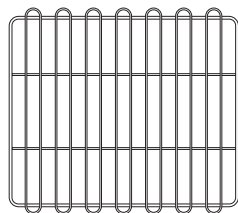

stainless Shelf(SUS 304)

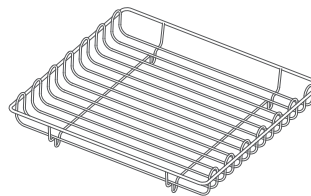

stainless Basket(SUS 304)



Power cord

4. Specifications

Model: Spectra UV sterilizer (Multi purpose sterilizer)
Input: AC 220~240, 50Hz/60Hz
Dry type: PTC heating
Weight: 5.5 Kg

External dimensions: 290(W) X 395(D) X 379(H)
Power consumption: 180W
Sterilize type: UV lamp

5. Components

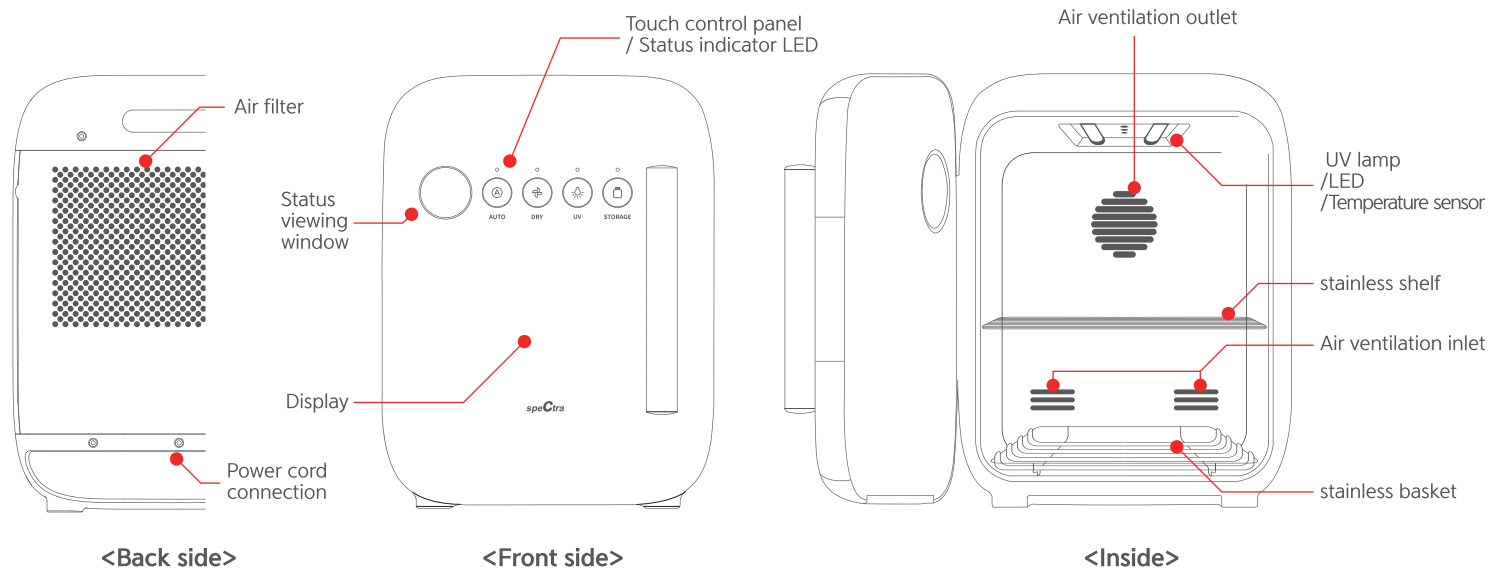

6. Unit installation and UV lamp replacement instructions

Take caution when installing stainless shelf/basket as this may cause scratch on the internal surface of the main unit. Exchange or return of the appliance will not be accepted after installation of stainless shelf/basket.

◉ stainless shelf Installation

Install the stainless shelf in the main unit by tilting it slightly like shown in the diagram and placing on the shelf holders.

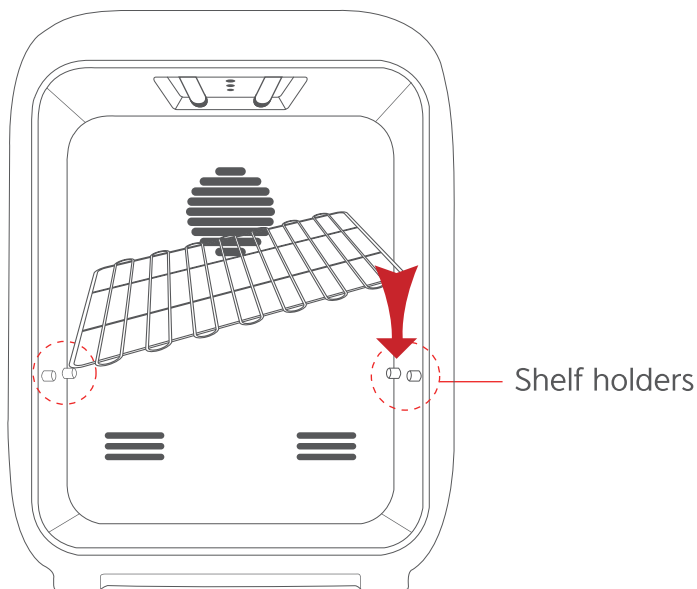

◉ stainless basket Installation

Install the stainless basket in the main unit by placing it upright at the bottom of the like shown in the diagram.

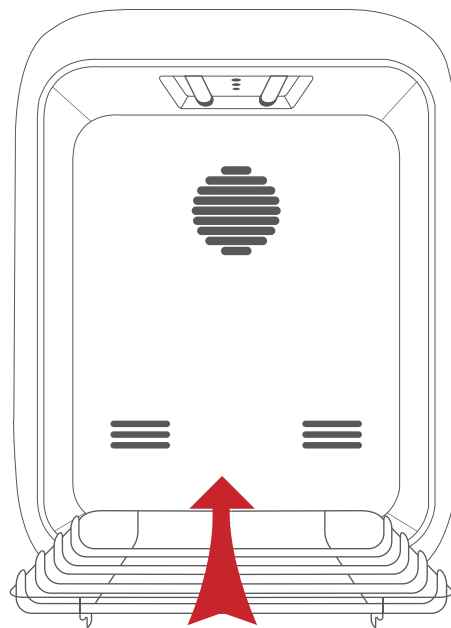

● UV lamp replacement

UV lamp must be replaced periodically.

Replacement timing may vary depending on usage period and environment.

When both ends of the lamp turn dark, this is an indication that the lamp has come to end of life and should be replaced with a new UV lamp.

For optimal sterilization, it is recommended that the lamp be replaced every 6 months.

To remove the UV lamp, hold both ends of the lamp (labelled A in the diagram) and rotate the tube 90 degrees in either direction until a click is heard.

The pins at the end of the tube should be aligned with the slots (labelled B in the diagram) in the sockets, allowing the lamp to be pulled out.

To install a new UV lamp, follow the removal process in reverse by placing the lamp into the sockets and rotating the tube 90 degrees until a click is heard.

※ The appliance must be unplugged from the power outlet when replacing UV lamp.
(Replacing a UV lamp is similar to replacing a fluorescent tube at home)

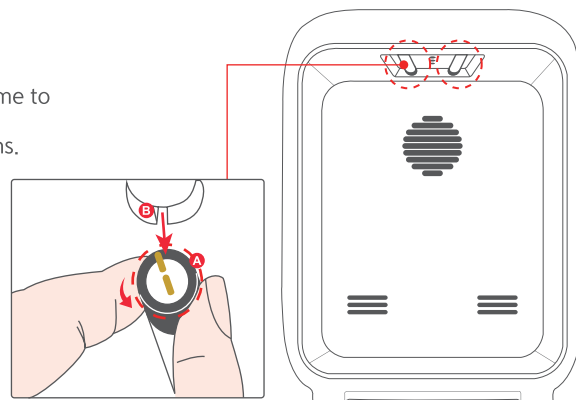

● Air filter cleaning

The air filter must be cleaned periodically.

Cleaning timing may vary depending on usage period and environment.

For optimal sterilization, it is recommended that the air filter be checked and cleaned on a monthly basis.

To remove the filter panel, hold the upper sides of the panel and pull it forward.

Clean the air filter by holding the filter panel under running water and shaking it lightly to remove any dust.

To replace the filter panel, hook in the bottom of the panel into place first then close the panel until a click is heard.

※ Cleaning with force using a brush or other cleaning equipment may damage the air filter.

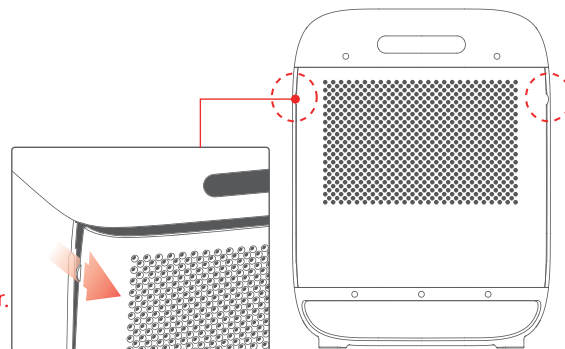

7. Operating instructions

There are four buttons on the touch control panel.

Select a course by touching on the corresponding button for a specified number of times.

※ When placing items such as bottles, ensure that any excess water is shaken off before placing in the appliance.



AUTO

Auto course 1 (total 20 min operation) / touch 1 time

Dry 10 min, sterilization 5 min, air ventilation 20 min

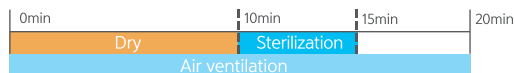

Auto course 2 (total 30 min operation) / touch 2 time

Dry 20 min, sterilization 5 min, air ventilation 30 min



Auto course 3 (total 40 min operation) / touch 3 time

Dry 30 min, sterilization 5 min, air ventilation 40 min



※ Touching 4 times will power off the appliance.



DRY

Dry course 1 (total 10 min operation) / touch 1 time

Dry 10 min, air ventilation 10 min



Dry course 2 (total 20 min operation) / touch 2 time

Dry 20 min, air ventilation 20 min



Dry course 3 (total 30 min operation) / touch 3 time

Dry 30 min, air ventilation 30 min



※ Touching 4 times will power off the appliance.



UV

UV course 1 (total 10 min operation) / touch 1 time

UV ventilation 5 min, air ventilation 10 min



UV course 2 (total 15 min operation) / touch 2 time

UV ventilation 10 min, air ventilation 15 min



※ Touching 3 times will power off the appliance.



STORAGE

Storage Course (total 10 hour operation) / touch 1 time

Sterilization 1min and air ventilation 1min every two hours



* Touching 2 times will power off the appliance.

Mute/Unmute / Touch and hold for 2 seconds



Touching and holding STORAGE button for 2 seconds will enable mute. Sound Off icon will show up on the display with a beep and turn off all sounds.



Touching and holding STORAGE button for 2 seconds will disable mute. Sound On icon will show up on the display with a beep and turn on all sounds.

8. How to use sterilizer

1. Open the main unit and clean the inside with a soft cloth.
(Do not clean with water. This will become a cause for damage of the product.)
2. Clean and dry the stainless shelf/basket components then install them inside the main unit.
(Appliance that has been scratched or damaged from stainless shelf/basket installation will not be accepted for exchanges or refunds)
3. It is common to smell odors from the appliance during the first use.
4. Plug the power cord to a power outlet.
5. Open the main unit and place items to be sterilized on the stainless shelf and basket.
6. Excess water should be shaken off all washed items such as bottles before placing in the appliance. Do not stack items together as any areas overlapped will limit the UV light exposure and not be sterilized properly. Items with an opening should be placed with the opening facing up.
Close the door once all items have been placed in the unit and start operation by selecting a course using the buttons on the touch control panel.
7. The appliance will not operate if the door is not closed properly, so check the door if the appliance does not start operation.
8. Use of appliance may result in discoloration of the inside of the main unit door and some items such as baby bottles and teats.
(This does not affect the product performance)
9. When the appliance is in operation, opening of the door to place or remove an item will pause the operation and will resume upon closing of the door.
10. When placing items to be sterilized inside the main unit, the items should be spaced out rather than packed closely together as this will maximize the sterilization effect.
11. The sterilizer will beep when starting and finishing an operation normally.
Use of the appliance may result in water stains, which will become a cause for bad odors.
The internal surfaces of the main unit should be wiped clean periodically with a soft cloth.
Never use rough scourers or chlorinated chemicals to clean the appliance as this will cause corrosion of stainless steel.

9. Troubleshooting

Check the following if the appliance does not operate normally.

- 1) Check if the power cord is plugged in properly.
 - 2) Check if the door is closed properly.
 - 3) If no sounds are heard, check if the appliance has been muted.
 - 4) Check if the UV lamp has been installed properly into the sockets.
 - 5) If the appliance was purchased more than 6 months ago, replace the UV lamps.
- ※If problem persists even after following the above troubleshooting instructions, contact the Customer Center (+82-70-5228-0983)

10. Limited warranty

This product is warranted by Uzinmedicare Co., Ltd. to the original retail purchaser to be free from defects in material and workmanship for the period of 1 years.

This warranty does not cover UV lamp or damage caused by accident, misuse, abuse, improper maintenance, unauthorized modification, or connection to an improper power supply. A charge will be made for repair of such damages.

WARRANTY CARD

Spectra UV sterilizer

Origin : Republic of Korea

Address : 54, 56, Dongtansandan 5-gil, Hwaseong-si, Gyeonggi-do, 18487, Republic of Korea

Telephone : +82-70-5228-0983



Spectra UV sterilizer	
Name	
Telephone	
Address	
Purchased date	

speCtra