

speCtra



SPECTRA Q

CE  
2460

UZ-IFU-SPQ(EN)  
Rev.008  
2021.09

# CONTENTS

1. Important Safeguards
2. Important Symbols
3. Indications for use
4. Components and assembly
5. Button Control
6. Pumping Guide
7. Getting started
8. How to use the dual pump
9. Cleaning and disinfection
10. How long can I store breast milk?
11. How do I thaw and use stored breast milk?
12. Use and Storage environment
13. Trouble shooting
14. Specifications
15. Limited Warranty
16. EMC

## 1. IMPORTANT SAFEGUARDS

### Warnings and Precautions

When using electrical products, especially when children are present, basic safety precautions should always be followed.

- ① If you are a mother who is infected with Hepatitis B, Hepatitis C or Human Immunodeficiency Virus (HIV), pumping breast milk will not reduce or remove the risk of transmitting the virus to your baby through your breast milk.
- ② Before each use visually inspect the individual components for cracks, chips, tears, discoloration or deterioration. In the event that damage to the device is observed, please discontinue use until the parts have been replaced.



#### READ ALL INSTRUCTIONS BEFORE USING.

When using electrical products, basic safety precautions should always be followed

This is a single user product.

Use by more than one person may present a health risk and performance questions and voids the warranty.



#### To reduce the risk of electrocution.

- ① DO NOT USE WHILE BATHING.
- ② DO NOT PLACE OR STORE PRODUCT WHERE IT CAN FALL OR BE PULLED.
- ③ DO NOT PLACE IN OR DROP INTO WATER OR OTHER LIQUOD.
- ④ DO NOT REACH FOR A PRODUCT THAT HAS FALLEN INTO WATER,  
UNPLUG THE PRODUCT IMMEDIATELY.
- ⑤ DO NOT SANITIZE THE KIT IN MICROWAVE OVEN, NEVER IMMERSE MAIN BODY IN WATER.





















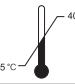

To reduce the risk of burns, electrocution, fire, or injury to persons.

- ① THIS PRODUCT SHOULD NEVER BE LEFT UNATTENDED WHEN PLUGGED IN.
- ② CLOSE SUPERVISION IS NECESSARY WHEN THIS PRODUCT IS USED NEAR INFANTS OR CHILDREN.
- ③ USE THIS PRODUCT ONLY FOR ITS INTENDED USE AS DESCRIBED IN THIS MANUAL. DO NOT USE ATTACHMENTS NOT RECOMMENDED BY THE Uzinmedicare Co., Ltd.
- ④ NEVER OPERATE THIS PRODUCT IF IT HAS A DAMAGED CORD OR PLUG. IF IT IS NOT WORKING PROPERLY, IF IT HAS BEEN DROPPED OR DAMAGED. DROPPED INTO WATER, OR IF ANY PARTS ARE BROKEN OR MISSING.
- ⑤ KEEP THE CORD AWAY FROM HEATED SURFACES.
- ⑥ NEVER USE WHILE SLEEPING OR DROWSY.
- ⑦ DO NOT USE OUTDOORS OR OPERATE WHERE AEROSOL SPRAY. PRODUCTS ARE BEING USED OR WHERE OXYGEN IS BEING ADMINISTERED.
- ⑧ THE AC/DC ADAPTOR CORD SHOULD BE UNPLUGGED FROM THE OUTLET WHEN NOT IN USE.
- ⑨ DO NOT DISASSEMBLE OR MODIFY THE PRODUCT.
- ⑩ DO NOT INHALE OR SWALLOW SMALL PARTS.
- ⑪ ALLERGIC REACTIONS MAY OCCUR.
- ⑫ LINT, DUST, LIGHT (INCLUDING SUNLIGHT), ETC CAN BE ADVERSELY AFFECT SAFETY AND ESSENTIAL PERFORMANCE.
- ⑬ AC/DC ADAPTOR MUST BE EASY TO UNPLUG POSITION DURING USAGE.
- ⑭ BE CAREFUL NOT TO DROP PRODUCT. IF DROPPED OR IMPACTED, CONTACT NEARBY SERVICE CENTER.
- ⑮ DO NOT USE ACCESSORIES OF OTHER BRAND WITH THIS PRODUCT. BREAST SHIELD OF THIS PRODUCT IS COMPLYING WITH BIOCOMPATIBILITY OF MEDICAL DEVICE.

If you feel pain in your breast or nipple, turn the pump off or adapter plug out and remove from your breast. Consult your healthcare professional (Suction can be broken by inserting finger between the breast and breast shield or by shutting the pump off)

## 2. Important Symbols

 <b>General Action sign</b>	 <b>Danger, Warning</b>	 <b>General prohibition sign</b>
 <b>Type BF</b>	 <b>DC</b>	 <b>Class II</b>
 <b>Power On / Off</b>	 <b>European representative</b>	 <b>Manufacturer</b>
 <b>Transport/Storage/Operation Humidity</b>	 <b>Operation temperature.</b>	 <b>Operation atmospheric pressure</b>
 <b>Fragile</b>	 <b>Keep dry</b>	 <b>Serial Number</b>
 <b>Date of manufacture</b>	 <b>This product should not be mixed with other commercial wastes for disposal.</b>	 <b>Do not pile</b>
 <b>Quality System</b>	 <b>CE certificate logo</b>	 <b>Refer to IFU</b>

### WARNING!

This is designed to be a single user product.

Use of this breast pump by anyone other than the original owner may present health risks, affect performance integrity and voids the product warranty.

### 3. Indications for use

The Spectra Q is powered, breast pump to be used by lactating women\* to express and collect milk from their breasts. The Spectra Q is intended for a single user.

### 4. Components and Assembly

**NOTE: (Parts may vary by country.)**



Before using the Spectra-Series breast pump for the first time, sanitize the breast shield kit in boiling water for 5 minutes. (Parts may bend if boiled for more than 5 minutes.)

**NOTE: (Do not boil for more than 5 minutes, as parts may become distorted.)**

\* Gender : Female / Age : Adult

## How to Assemble the Back-Flow Protector

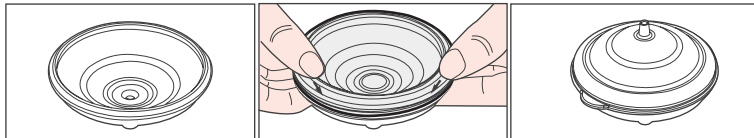

- (1) Insert the white silicone membrane into lower case.
- (2) Insert upper case into assembled silicone membrane.

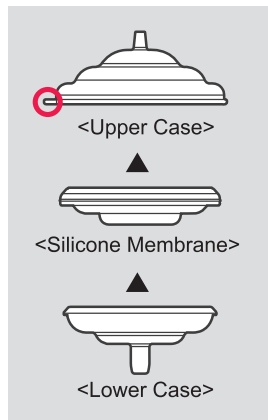

## How to Assemble the Pump Kit

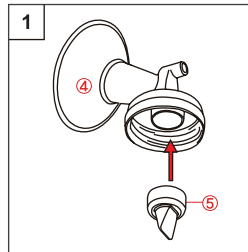

<Push ⑤ Silicone valve onto  
④ Breast shield>

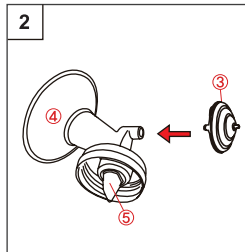

<Insert ③ Back-flow Protector into  
④ Breast shield>

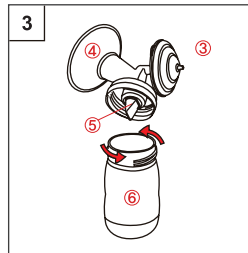

<Screw ⑥ Bottle into  
④ Breast shield>

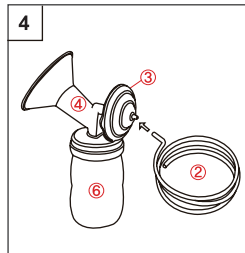

<Insert ② Tubing into  
③ Back-flow Protector>

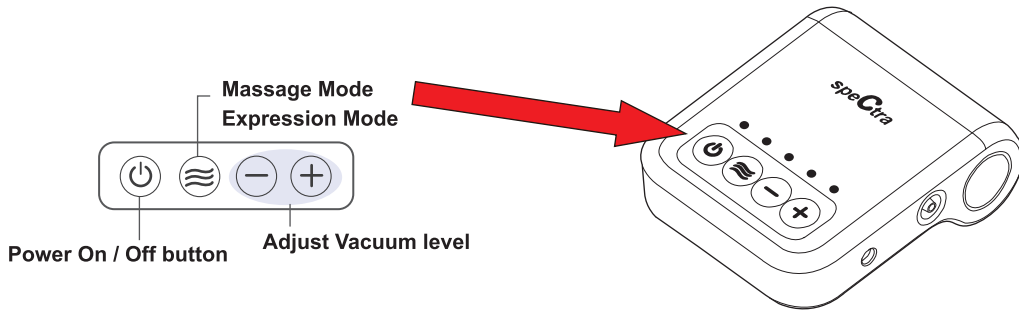

## 6. Pumping guide

- 1) Relax and stimulate your let-down reflex.
- 2) Gently massage your breasts or apply warm compresses from the back of the breast toward the nipple before using.
- 3) Express milk from each breast for 10-15 minutes.

**NOTE: For maximum milk expression, we recommend that you pump frequently but in short increments**

**(10-15 minutes per breast, every 2-3 hours, 7-8 times a day)**

**NOTE : EVEN WHEN YOU ARE USING THE BREAST PUMP,  
BREASTFEED YOUR BABY WHENEVER YOU CAN.**



## 7. Getting started

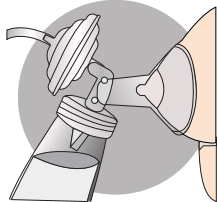

1. Center the breast shield on your breast so that the nipple is drawn into the flange.

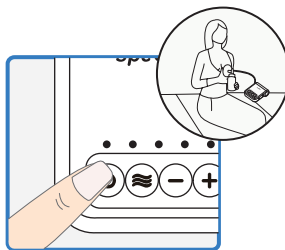

2. Press the power button. The screen will light up and begin.

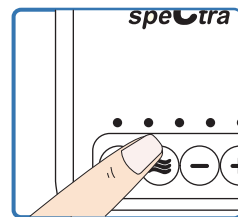

3. Press the Massage/Expression button to change to expression mode once your milk starts flowing

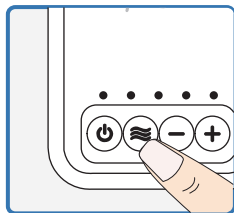

4. Adjust the vacuum (+) (-) to comfort level. (never set high enough to cause discomfort)

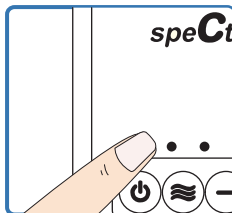

5. When you wish to stop expressing, press the power button then remove milk collection from your breast.

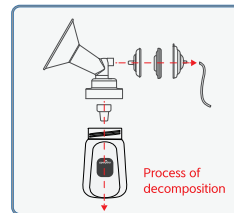

6. Disconnect the backflow protector from the breast shield. Remove the breast shield from the milk collection bottle and close the bottle tightly with bottle cap & disk and store safely.

### ● Vacuum Setting

Please be cautious when setting the vacuum level on Spectra Q.

Some women find that milk expression is faster on higher vacuum levels.

However, it is important not to set the vacuum level so high that it makes you uncomfortable, as the resulting pain will hinder your milk flow.

We therefore suggest that you start off with the vacuum level on low, and then gradually increase the vacuum level to a comfortable level. You may find that the vacuum level that you are comfortable with varies significantly, from day to day, during the day and even during the same expression session.

Adjust the vacuum level by pressing the   buttons.

### ● Massage and Expression Modes.

- Massage mode : You will adjust the Vacuum level in massage mode to find what works best for you.
- Expression mode : After letdown begins, and once the milk is flowing, your baby will start sucking more slowly and deeply, creating a stronger suction to draw down the milk.  
This mode has a slower cycle speed and higher vacuum level.  
Please adjust the cycle speed and vacuum level in expression mode to find what works best for you.

**NOTE : The Spectra Q will remember your settings automatically for your next session.**

**If you want to start pumping on settings different from those used during your previous session, adjust the settings before you start expressing.**

## 8. How to use the dual pump

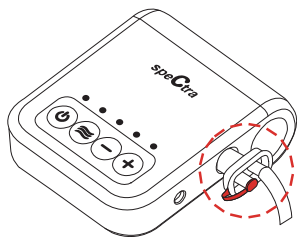

1) Remove the air cap

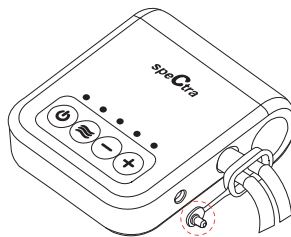

2) Connect tubing from each milk collection kit to an air nozzle.

## 9. Cleaning and Disinfection

### 1) First time use

- Before using Spectra Q breast pump for the first time, disassemble and wash all parts that come into contact with the breast and breastmilk .

### 2) After every use

- ① Disassemble and wash all parts of your pump kit that come into contact with the breast and breastmilk (breast shield, Silicone valve, nipple, cover, disk and cap) in warm, soapy water.  
All parts in the pump kit are dishwasher safe.
- ② Rinse in clean water.
- ③ Air-dry and cover parts when not in use.

**NOTE: TO ELIMINATE CONDENSATION OR MILK IN THE TUBING, WASH AND DRY IT IMMEDIATELY.**

**TO CLEAN MAIN BODY, WIPE MAIN BODY WITH A CLEAN DAMP CLOTH.**

**Inspect the tubing for condensation or milk. If any condensation or milk is noted in the air tube, wash and dry it immediately or replace the tubing.**

## 10. How long can I store breast milk ?

### At Room Temperature:

Temperature	Storage Time
15°C (60°F)	24 hours
26°C (79°F)	4 to 6 hours
30°C (86°F)	4 hours

### In the Refrigerator:

Temperature	Storage Time
0°C~4°C (32°F~39°F)	Up to 8 days

### In the Refrigerator:

Type	Storage Time
Compartment Contained within a refrigerator	Up to 2 weeks
Self-Contained Bottom, top mount, side-by-side, or stand alone freezer	3 to 4 months
Deep Freezer With a constant -17°C (0°F) temperature	6 to 12 months

Source: Breastfeeding Made Easier at Home and Work, womenshealth.gov

## 11. How do I thaw and use stored breast milk?

- Always make sure to check the date on the milk's container before using. Do not use undated milk, or milk that has been stored too long.
- Thaw frozen milk in the refrigerator or under cool, running water.
- Heat the milk under warm, running water and gently swirl the container to mix the milk.
- If warm water is not available, heat a pan of water on the stove. Once the water is warm, not boiling, remove the pan from the stove and place the milk container in the pan. Never warm the milk container directly on the stove.
- Never microwave breast milk because microwaves can cause dangerous hot spots that could burn you or a baby.
- Always test the temperature of the milk on the inside of your wrist before feeding it to a baby. The milk should feel warm, not hot.
- After thawing, milk should be stored in the refrigerator for no more than 24 hours.
- Never refreeze thawed milk. Throw away previously frozen milk that is not used within 24 hours.

## 12. Use and Storage environment

### Environment to Use

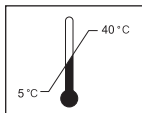

Temperature

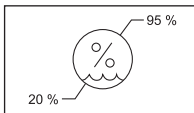

Humidity

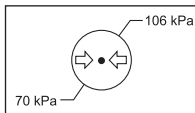

Pressure

### Environment to storage

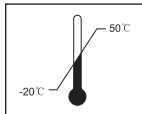

Temperature

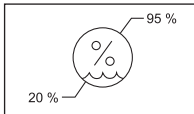

Humidity

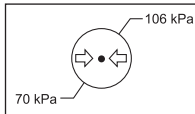

Pressure

### 13. Trouble shooting

Condition	Possible Causes	Checks	Solutions
No Power	Adaptor	Check if the power cord is not connected or it has damaged.	Plug into the outlet. If it has damaged, Contact manufacturer or service center or where you purchased.
No Suction	Air tube	Check the tubing is connected to the main body.	Connect the air tube to the main body.
	Valve	Check if they are connected to breast shield properly.	Disassemble and reassemble them properly.
	Air cap	Check if the air cap is closed.	Close the air cap.
Low Suction	Vacuum Level	Check if there is a low vacuum level on the vacuum regulator valve or if there is an abnormal noise.	Contact the location where you purchased the product or the manufacturer.
	Defective assembly kit	Check the connection of the kit.	Disassemble and reassemble them.
	Breast shield	Check if there is problem with the breast shield.	Purchase and replace the breast shield.
	Valve	Check if there is damaged in valve head.	Replace the valve.
Pain	Too high suction	Check the suction level.	Set to the lowest suction level and consult your lactation consultant or physician.

#### 14. SPECIFICATIONS

Protection Type : Class II

Weight : 160g, Power consumption: 10VA

Adapter Input : 100-240V~50/60Hz, 500mA

Output : 6V=== 1A

Function

- Level : 1~5(Expression) / 1~5(Massage)
- Vacuum : 150~300mmHg(Expression) / 50~150mmHg(Massage)

1. Type of protection against electric shock: Class II equipment
2. Degree of protection against electric shock: Type BF applied parts
3. Classification according to the degree of protection against ingress of water: IP22
4. This equipment is not suitable for use in the presence of flammable anesthetics or oxygen
5. Mode of operation: continuous operation

#### 15. LIMITED WARRANTY

This product is warranted by Uzinmedicare Co., Ltd.

to the original retail purchaser to be free from defects in material and workmanship for a period of 2 years from the date of purchase.

This warranty does not cover damage caused by accident, misuse, abuse, improper maintenance, unauthorized modification, or connection to an improper power supply. A charge will be made for repair of such damages.

#### WARRANTY CARD

Spectra Q

Origin : Korea Rep

Address : Uzinmedicare Co., Ltd.

54, 56, Dongtansandan 5-gil, Hwaseong-si, Gyeonggi-do, 18487, Republic of Korea

Tel : +82-70-5228-0983 / [www.uzinmedicare.com](http://www.uzinmedicare.com)

Spectra Q Electric Breast pump			
Name		Mobile Phone	
Telephone		Address	

## 16. EMC

This equipment needs to be installed and put into service in accordance with the information provided in the user manual [IEC/EN 60601-1-11:2010 Clause 12.3a]

Wireless communications equipment such as wireless home network devices, mobile phones, cordless telephones and their base stations, walkie-talkies can affect this equipment and should be kept at least a distance 1.0m away from the equipment. [IEC/EN 60601.1.11:2010 Clause 12.3b]

This equipment has been tested and found to comply with the limits for medical devices in IEC 60601-1-2:2014.

These limits are designed to provide reasonable protection against harmful interference in a typical medical installation.

This equipment generates, uses and can radiate radio frequency energy and if not installed and used in accordance with the instructions, may cause harmful interference to other devices in the vicinity.

However, there is no guarantee that interference will not occur in a particular installation.

If this equipment does cause harmful interference to other devices,

which can be determined by turning the equipment off and on, the user is encourage to try to correct the interference by one or moer of the following measures.

- Reorient of relocate the receiving device.
  - Increase the separation between the equipment.
  - Connect the equipment into an outlet on a circuit different from that to which the other device(s) are connected.
- Consult the manufacturer or field service technician for help.