

SPECTRA DUAL COMPACT

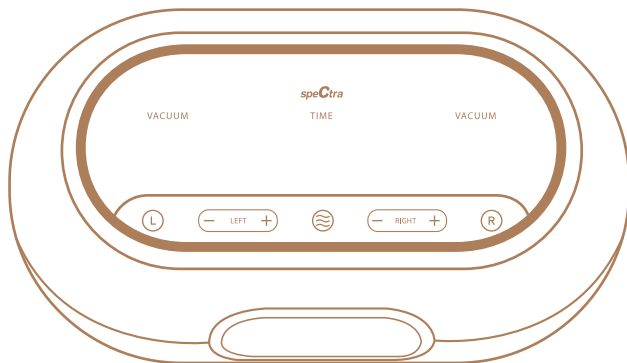

Premium Electric Breast Pump
Instruction for use

speCtra

Contents

1. Important Safeguards	5
2. Important Symbols	7
3. Indications for use	
4. Components and assembly	8
5. Display	11
6. Button Control	
7. Pumping Guide	12
8. Getting started	
9. How to use the dual pump	15
10. Cleaning and disinfection	

11. How long can I store breast milk?	16
12. How do I thaw and use stored breast milk?	17
13. Trouble shooting	18
14. Use and Storage environment	
15. Specifications	19
16. Limited Warranty	
17. EMC	20

Simple & Modern Style

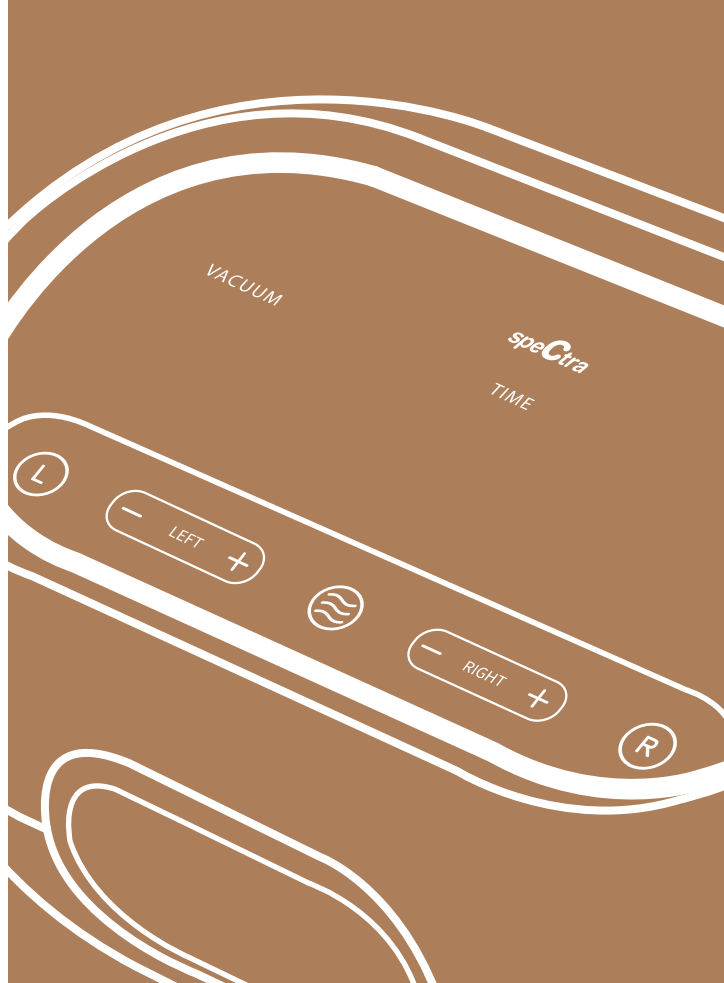



VACUUM

SPECTRA DUAL COMPACT

Premium Electric Breast Pump

1. IMPORTANT SAFEGUARDS

Warnings and Precautions

When using electrical products, especially when children are present, basic safety precautions should always be followed.

- ① If you are a mother who is infected with Hepatitis B, Hepatitis C or Human Immunodeficiency Virus (HIV), pumping breast milk will not reduce or remove the risk of transmitting the virus to your baby through your breast milk.
- ② Before each use visually inspect the individual components for cracks, chips, tears, discoloration or deterioration. In the event that damage to the device is observed, please discontinue use until the parts have been replaced.



READ ALL INSTRUCTIONS BEFORE USING.

When using electrical products, basic safety precautions should always be followed. This is a multiple-users product.



To reduce the risk of electrocution,

- ① DO NOT USE WHILE BATHING.
- ② DO NOT PLACE OR STORE PRODUCT WHERE IT CAN FALL OR BE PULLED.
- ③ DO NOT PLACE IN OR DROP INTO WATER OR OTHER LIQUID.
- ④ DO NOT REACH FOR A PRODUCT THAT HAS FALLEN INTO WATER, UNPLUG THE PRODUCT IMMEDIATELY.
- ⑤ DO NOT SANITIZE THE KIT IN MICROWAVE OVEN, NEVER IMMERSE MAIN BODY IN WATER.





















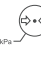

To reduce the risk of burns, electrocution, fire, or injury to persons.

- ① THIS PRODUCT SHOULD NEVER BE LEFT UNATTENDED WHEN PLUGGED IN.
- ② CLOSE SUPERVISION IS NECESSARY WHEN THIS PRODUCT IS USED NEAR INFANTS OR CHILDREN.
- ③ USE THIS PRODUCT ONLY FOR ITS INTENDED USE AS DESCRIBED IN THIS MANUAL.
DO NOT USE ATTACHMENTS NOT RECOMMENDED BY THE UZINMEDICARE Corporation.
- ④ NEVER OPERATE THIS PRODUCT IF IT HAS A DAMAGED CORD OR PLUG.
IF IT IS NOT WORKING PROPERLY, IF IT HAS BEEN DROPPED OR DAMAGED,
DROPPED INTO WATER, OR IF ANY PARTS ARE BROKEN OR MISSING.
- ⑤ KEEP THE CORD AWAY FROM HEATED SURFACES.
- ⑥ NEVER USE WHILE SLEEPING OR DROWSY.
- ⑦ DO NOT USE OUTDOORS OR OPERATE WHERE AEROSOL SPRAY,
PRODUCTS ARE BEING USED OR WHERE OXYGEN IS BEING ADMINISTERED.
- ⑧ THE AC/DC ADAPTOR CORD SHOULD BE UNPLUGGED FROM THE OUTLET WHEN NOT IN USE.
- ⑨ DO NOT DISASSEMBLE OR MODIFY THE PRODUCT.
- ⑩ Do not Inhale or swallow small parts
- ⑪ Allergic reactions may occur
- ⑫ Lint, dust, light (including sunlight), etc can be adversely affect safety and essential performance.
- ⑬ AC/DC adaptor must be easy to unplug position during usage.

If you feel pain in your breast or nipple, turn the pump off or adapter plug out and remove from your breast. Consult your healthcare professional (Suction can be broken by inserting finger between the breast and breast shield or by shutting the pump off)

2. Important Symbols

 General Action sign	 Danger, Warning	 General prohibition sign
 Type BF	 DC	 Class II
 Power On / Off	 Refer to IFU	 Manufacturer
 Transport/Storage/ Operation Humidity	 Operation temperature	 Operation atmospheric pressure
 Fragile	 Keep dry	 Serial Number
 Date of manufacture	 This product should not be mixed with other commercial wastes for disposal.	 Do not pile
 Quality System	 Distributor	 CE certificate logo

3. Indication for use/Intended use

The Spectra dual compact is a powered breast pump to be used by lactating women to stimulate, express and collect milk from their breasts. The electric breast pump can be used to pull out flat or inverted nipples so a nursing baby can latch on more easily. The Spectra dual compact is intended for multiple users. The breast shield kit is for personal use only.

- Contraindication – Women who are infected with Hepatitis B, Hepatitis B or HIV or any virus.
- Patient populations – A woman who is breastfeeding an infant / Gender : Female / Age : Adult

4. Components and Assembly

Before using Spectra-series breast pump for the first time, sanitize the breast shield kit in boiling water for 5 minutes.(Parts may bend if boiled for more than 5 minutes.)

NOTE: (Parts may vary by countries)



① Pump unit



② Tubing

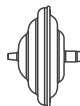

③ Back-flow
Protector



④ Breast Shield



⑤ Silicone Valve



⑥ Cover



⑦ Cap



⑧ Bottle

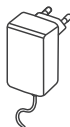

⑨ Adapter



⑩ Nipple



⑪ Airtight Cap

Warning

These pump kits are designed to be a single-user. Never to share the kits. Use of this breast pump kit by anyone other than the original owner may present health risks, affect performance integrity and voids the product warranty. Clean the pump properly, between users.

NOTE : Do not boil for more than 5 minutes, as parts may become distorted.

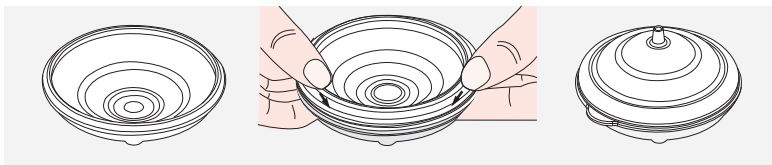
How to assemble Back-flow Protector

- (1) Insert the white silicone membrane into lower protector
- (2) Insert upper protector into assembled silicone membran

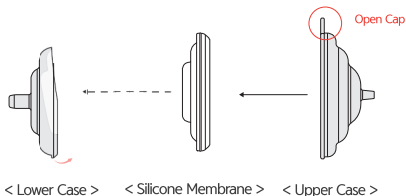

How to assemble Pump Kit

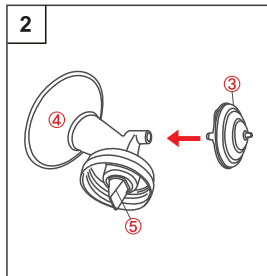
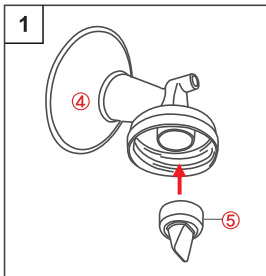

Push ⑤silicone valve onto ④Breast shield Insert ③Back-flow Protector into ④Breast shield

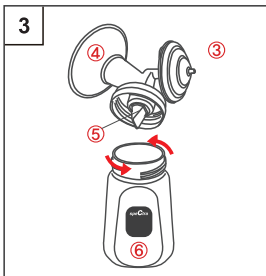

Screw ⑥Bottle into ④Breast shield

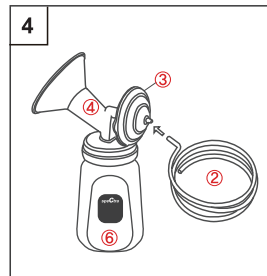

Insert ②Tubing into ③Back-flow Protector

5. Display

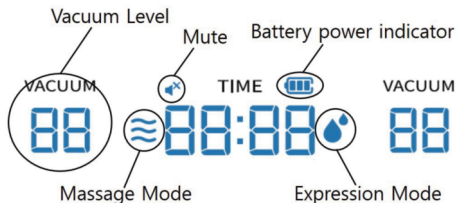

6. Button Control

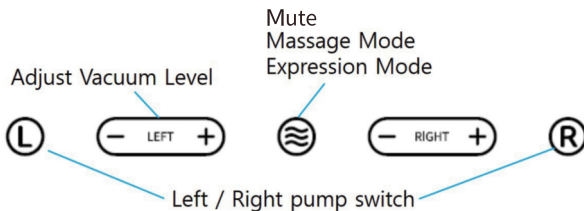







- **Left/Right pump switch**
Left or Right pump selection button
- **2-Phase Mode : Message Mode** / **Expression Mode**
To select the Message Mode and Expression Mode, press the buttons.
Each symbol appears, on the right or left of the Timer Display, depending on the mode that is being used.
- **Adjust Vacuum Level**
Vacuum mode – 1~12 level / Message mode – 1~5 level
To adjust the vacuum level and message mode, press the +/- buttons.

7. Pumping guide

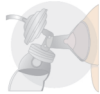
- 1) Relax and stimulate your let-down reflex.
- 2) Gently massage your breasts or apply warm compresses from the back of the breast toward the nipple before using.
- 3) Express milk from each breast for 10–15 minutes and it is good to alternate breasts.
It is more effective and better for the breasts when you pump frequently than pumping for a long time.
(Every 2–3 hours, 8 times a day)

NOTE : EVEN WHEN YOU ARE USING THE BREAST PUMP, BREASTFEED YOUR BABY WHENEVER YOU CAN.

8. Getting started

 <p>1. Center the breast shield on your breast so that the nipple is drawn into the flange.</p>	 <p>2. Insert the power adapter into the pump motor, and then plug it into the outlet. Press the power button. The screen will light up and begin.</p>	 <p>3. Press Massage/Expression button to change to expression mode once your milk starts flowing.</p>
 <p>4. Select the L and/or R button. Adjust the vacuum + - to comfort level (never set high enough to cause discomfort).</p>	 <p>5. When you wish to stop expressing, press the L or R button then remove milk collection kit from your breast.</p>	 <p>6. Disconnect the backflow protector from the breast shield. Remove the breast shield from the milk collection bottle and close the bottle tightly with bottle lid and store safely.</p>

○ Mute and Unmute

Touching and holding  button for 4 seconds will enable mute.

Mute icon  will show up on the display with a beep and turn off all sounds.

Touching and holding  button for 4 seconds will disable mute.

○ Vacuum Setting

The Vacuum level is measured in mmHg on your breast pump and refers to how strongly the pump will 'suck'. Please be cautious when setting the vacuum level on the Spectra dual compact. Some women find that milk expression is faster on higher vacuum levels. However, it is important not to set the vacuum level so high that it makes you uncomfortable, as the resulting pain will hinder your milk flow.

We therefore suggest that you start off with the vacuum level on low, and then gradually increase the vacuum level to a comfortable level. You may find that the vacuum level that you are comfortable with varies significantly, from day to day, during the day and even during the same expression session.

Adjust the vacuum level by pressing the   buttons.

○ Message and Expression Modes.

- Message mode :You will adjust the vacuum level in message mode to find what works best for you.
- Expression mode : After letdown begins, and once the milk is flowing, your baby will start sucking more slowly and deeply, creating a stronger suction to draw down the milk. This mode has a slower cycle speed and higher vacuum level. Please adjust the cycle speed and vacuum level in expression mode to find what works best for you.

Note

The Spectra dual compact will remember your settings automatically for your next session. If you want to start pumping on different settings to those you finished within your previous session, adjust the settings before you start expressing.

9. How to use the dual pump

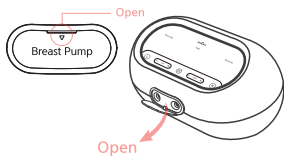

1) Remove the air cap

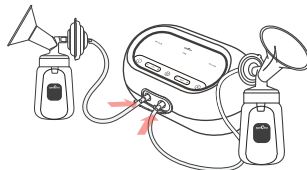

2) Connect tubing from each milk collection kit to an air nozzle.

10. Cleaning and disinfection

1) First time use

– Before using Spectra dual compact breast pump for the first time, sanitize all parts (except tubing and pump unit) in boiling water for 5 minutes.

- ① Disassemble all parts that come into contact with the breast and breast milk.
- ② Select a large stock pot large enough for all of your all parts to fit without pressing against each other.
- ③ Fill the pot with enough water to cover all parts and boil for 5 minutes.
- ④ Use a pair of tongs to carefully remove each part and set on a clean paper towel.
- ⑤ Allow to air-dry thoroughly before storing.
- ⑥ Once the parts are dry, assemble the pump before you store or use it.

Source: <https://www.cdc.gov/healthywater/hygiene/healthychildcare/infantfeeding/cleansanitize.html>

2) After every use

- ① Disassemble and wash all parts of your pump kit that come into contact with the breast and breastmilk (breast shield kit, Silicone valve, nipple, cover, disk and cap) in warm, soapy water.

All parts in the pump kit are dishwasher safe.

- ② Rinse in clean water
- ③ Air-dry and cover parts when not in use.

Note

To eliminate condensation or milk in the air tube, wash and dry it immediately.

To clean main body, wipe main body with a clean damp cloth.

Inspect the tubing for condensation or milk. If any condensation or milk is noted in the air tube, wash and dry it immediately or replace the tubing.

11. How long can I store breast milk?

At Room Temperature

Temperature	Storage Time
15°C (60°F)	24 hours
26°C (79°F)	4 to 6 hours
30°C (86°F)	4 hours

In the Refrigerator

Temperature	Storage Time
0°C–4°C (32°F–39°F)	Up to 8 days

In the Freezer

Type	Storage Time
Compartment Contained within a refrigerator	Up to 2 weeks
Self-Contained Bottom, top mount, side-by-side, or stand alone freezer	3 to 4 months
Deep Freezer With a constant -17°C (0°F) temperature	6 to 12 months

Source: Breastfeeding Made Easier at Home and Work, womenshealth.gov

12. How do I thaw and use stored breast milk?

- Always make sure to check the date on the milk's container before using. Do not use undated milk, or milk that has been stored too long.
- Thaw frozen milk in the refrigerator or under cool, running water.
- Heat the milk under warm, running water and gently swirl the container to mix the milk.
- If warm water is not available, heat a pan of water on the stove. Once the water is warm, not boiling, remove the pan from the stove and place the milk container in the pan. Never warm the milk container directly on the stove.
- Never microwave breast milk because microwaves can cause dangerous hot spots that could burn you or a baby.
- Always test the temperature of the milk on the inside of your wrist before feeding it to a baby. The milk should feel warm, not hot.
- After thawing, milk should be stored in the refrigerator for no more than 24 hours.
- Never refreeze thawed milk. Throw away previously frozen milk that is not used within 24 hours.

13. Trouble shooting

Condition	Possible Causes	Checks	Solutions
No Power	Adaptor	Check if the power cord is not connected or it has damaged.	Plug into the outlet. If it has damaged, Contact manufacturer or service center or where you purchased.
Low Suction	Air tube	Check the tubing is connected to the main body.	Connect the air tube to the main body.
	Vacuum Level	Check if there is a low vacuum level on the vacuum regulator valve or if there is an abnormal noise.	Contact the location where you purchased the product or the manufacturer.
	Defective assembly kit	Check the connection of the kit.	Disassemble and reassemble them.
	Breast shield	Check if there is problem with the breast shield.	Purchase and replace the breast shield.
	Valve	Check if there is damaged in valve head.	Replace the valve.
Pain	Too high suction	Check the suction level.	Set to the lowest suction level and consult your lactation consultant or physician.

14. Use and Storage environment

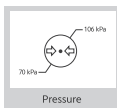
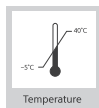

Environment to Use

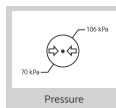
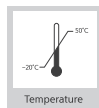

Environment to storage

15. SPECIFICATIONS

Protection Type : Class II

Weight : 670g

Expected Spectra dual compact Service Life is 3 years

The following adapter must be used.

Manufacturer: Dongguan Shilong Fuhua Electronic Co., Ltd.

Model: UES12LCP-050200SPA

Input: 100~240 V~ 50/60 Hz, 500 mA

Output: 5 V d.c., 2 A

Battery: Li-Polymer 7.4V 1,700mAh.

1. Type of protection against electric shock: Class II equipment
2. Degree of protection against electric shock: Type BF applied parts
3. Classification according to the degree of protection against ingress of water: IP22
4. This equipment is not suitable for use in the presence of flammable anesthetics or oxygen
5. Mode of operation: continuous operation

VACUUM SUCTION PRESSURE(mmHg)	CYCLE SPEED(cpm)
Expression Mode : 50~270 (Max. 270mmHg) Massage Mode : 50~130	Expression Mode : 26 Massage Mode : 100

16. LIMITED WARRANTY

This product is warranted by Uzinmedicare Co., Ltd. to the original retail purchaser to be free from defects in material and workmanship for the period of 2 years.

This warranty does not cover damage caused by accident, misuse, abuse, improper maintenance, unauthorized modification, or connection to an improper power supply. A charge will be made for repair of such damages.

Warranty card

Origin : Korea Rep

Address : 54,56, Dongtansandan 5-gil, Hwaseong-si, Gyeonggi-do, 18487, Republic of Korea

Telephone : +82-70-5228-0983

Spectra dual Compact Electric Breast pump	Name
Telephone	Mobile Phone
Address	

Disposal

This product contains electrical waste or electronic equipment. It must not be disposed of as unsorted municipal waste and must be collected separately in accordance with applicable national or institutional related policies relating to obsolete electronic equipment.

17. EMC

This equipment needs to be installed and put into service in accordance with the information provided in the user manual [IEC/EN 60601-1-11:2010 Clause 12,3a]

Wireless communications equipment such as wireless home network devices, mobile phones, cordless telephones and their base stations, walkie-talkies can affect this equipment and should be kept at least a distance 1.0m away from the equipment. [IEC/EN 60601-1-11:2010 Clause 12,3b]

This equipment has been tested and found to comply with the limits for medical devices IEC 60601-1-2:2014. These limits are designed to provide reasonable protection against harmful interference in a typical medical installation. This equipment generates, uses and can radiate radio frequency energy and if not installed and used in accordance with the instructions, may cause harmful interference to other devices in the vicinity. However, there is no guarantee that interference will not occur in a particular installation. If this equipment does cause harmful interference to other devices, which can be determined by turning the equipment off and on, the user is encouraged to try to correct the interference by one or more of the following measures,-

- Reorient or relocate the receiving device.
- Increase the separation between the equipment.
- Connect the equipment into an outlet on a circuit different from that to which the other device(s) are connected. Consult the manufacturer or field service technician for help.



Uzinmedicare Co., Ltd.

54, 56, Dongtansandan 5-gil, Hwaseong-si,
Gyeonggi-do, 18487, Republic of Korea
Tel. : +82-70-5228-0983
www.uzinmedicare.com



Masai Medical Equipment Trading

Dubai, United Arab Emirates
Tel. : +971 4 565 791, Mob. : +971 58 590 5103
contact@spectrababy.ae
www.spectrababy.ae

UZ-IFU-DUAL C(EN)/Rev.004/2021.11